

ADAQUO



Les Résidences Bieha



Wohnungen zu verkaufen - Apartments for sale

Adaquo
Chalet Zentrum
Untergstaadstr. 24
3780 Gstaad
Tel 033 744 30 03
info@adaquo.ch

	Etage	Désignation	Lot PPE	N°	0/00	Nbre pièces	Cave	Appart.	Balcon	Terrasse	Pondéré	CHF/m ²	ARRONDI	Charges annuelles budgétées									
																0,2				0,4		~	
																				m ²	m ²	m ²	m ²
Chevreuil	REZ	MAG-01-1 ouest	1065-27	1	26	Commerce	11,13	98,87	-	-	98,87	8000	SOLD	3588	VENDU								
		MAG-01-2 est	1065-28	2	25	Commerce	11,13	96,98	-	-	96,98	8000	776000	3450									
	1ER	AP01-1 est	1065-29	3	18	2,5	16,29	39,25	33,6	-	56,05	10000	560000	2484	R. principale								
		AP01-2 est	1065-30	3	27	2,5	21,88	66,81	34,6	-	84,11	10000	841000	3726	R. principale								
		AP01-3 ouest	1065-31	4	28	2,5	22,82	69,26	35,9	-	87,21	10000	872000	3864	R. principale								
		AP01-4 ouest	1065-32	5	13	1,5	16,29	27,29	27,1	-	40,84	10000	408000	1794	R. principale								
	ATTIQUE	AP01-5 est	1065-33	7	41	3,5	23,32	108,66	41,0	-	129,16	15000	1938000	5658									
		AP01-6 ouest	1065-34	8	40	3,5	23,47	106,7	33,2	-	123,3	15000	1850000	5520									
Cerf	REZ	MAG-02-1 ouest	1065-35	9	29	Commerce	10,76	111,38	-	-	111,38	8000	891000	4002									
		MAG-02-2 centre	1065-36	10	13	Commerce	-	51,05	-	-	51,05	8000	408000	1794									
		MAG-02-3 est	1065-37	11	29	Commerce	9,63	110,67	-	-	110,67	8000	885000	4002									
	1ER	AP-02-1 est	1065-39	12	58	4,5	23,5	149,1	68,17	-	185,5	10000	1855000	8004	R. principale								
		AP-02-2 ouest	1065-38	13	54	4,5	22,56	137,51	70,85	-	173,91	10000	SOLD	7452	VENDU								
	2EME	AP-02-3 est	1065-40	14	58	4,5	23,63	149,32	68,17	-	185,72	10000	SOLD	8004	VENDU								
		AP02-4 ouest	1065-41	15	54	4,5	22,14	137,74	70,85	-	174,14	10000	SOLD	7452	VENDU								
		AP-02-5	1065-42	16	90	7,5	24,5	256,26	52,17	-	283,61	15000	SOLD	12420	VENDU								
Chamois	REZ	AP-03-1 est	1065-43	17	47	3,5	20,23	116,3	-	72,41	158,89	11000	1748000	6486	R. principale								
		AP-03-2 ouest	1065-44	18	49	3,5	24,6	116,29	-	85,2	152,5	11000	1677000	6762	R. principale								
	1ER	AP-03-3 est	1065-45	19	46	3,5	20,75	115,26	63,83	-	145,9	10000	1459000	6348	R. principale								
		AP-03-4 ouest	1065-46	20	46	3,5	20,23	115,25	61,25	-	147,16	10000	1472000	6348	R. principale								
	2EME	AP-03-5 est	1065-47	21	46	3,5	22,75	115,26	63,83	-	145,9	10500	1532000	6348	R. principale								
		AP-03-6 ouest	1065-48	22	46	3,5	20,48	115,25	61,25	-	147,16	10500	réservé	6348	réservé								
	ATTIQUE	AP-03-7-2	1065-49	23	82	6,5	24,44	233,64	49,8	-	258,54	18000	4654000	11316									

PARKING places intérieures à

60'000

résidences secondaires









Adaquo, Chalet Zentrum, Untergstaadstr. 24, 3780 Gstaad, Tel 033 744 30 03

info@adaquo.ch

adaquo.ch

Area
Region

Saanen

-  - Train station / Bahnhof
-  - Bus
-  - Taxi
-  - Bank
-  - School / Schule
-  - Restaurant
-  - Bakery / Bäckerei
-  - Fitness

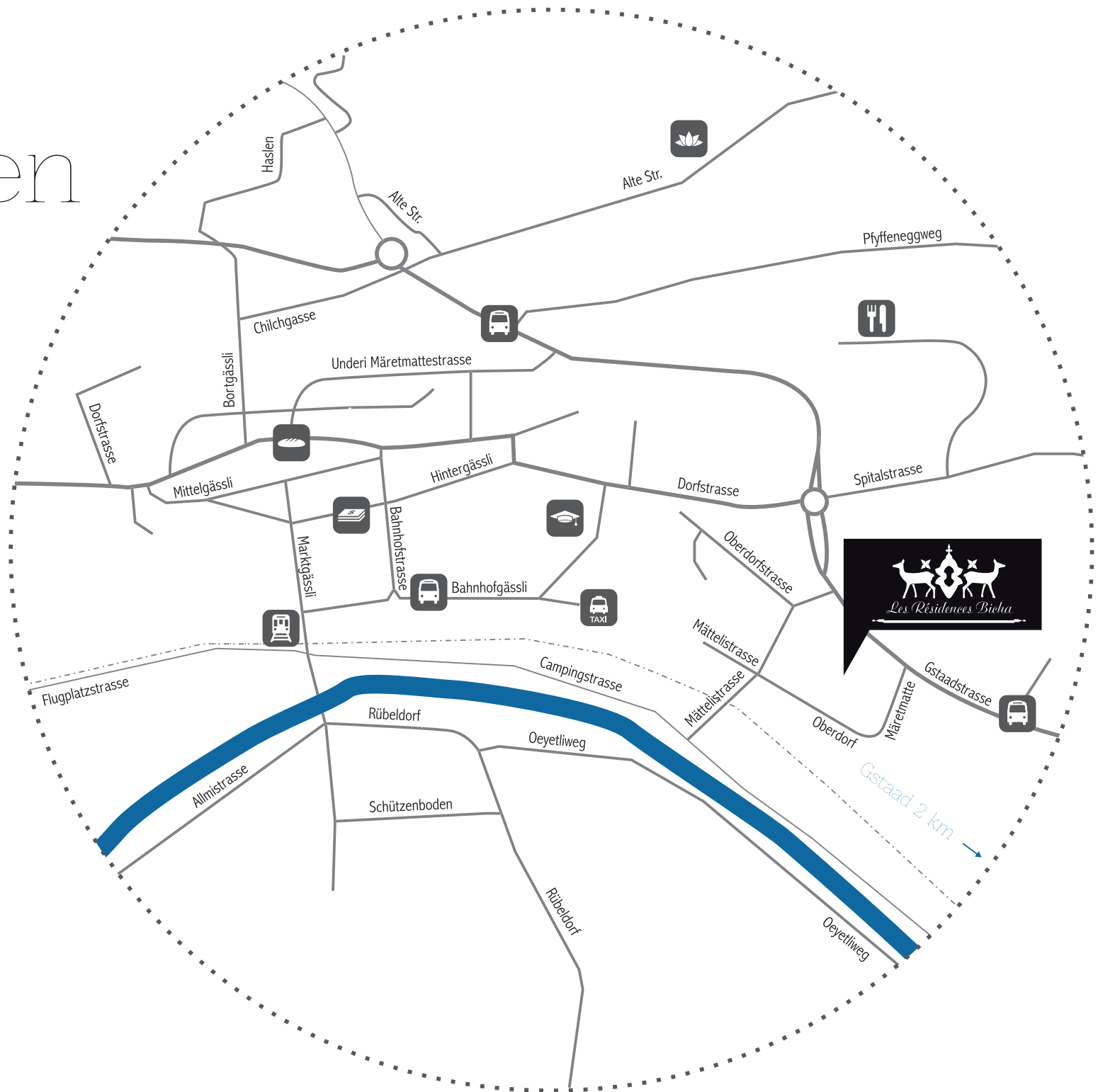



Just a stone's throw from the famous resort of Gstaad, this luxury residence comprises 4 Chalets, connected by garages. The residence will contain 28 apartments and 5 shops, shared among the 4 chalets. This ambitious project has been guided by the search for harmony, with authentic, modern and environmentally friendly materials. Indeed, the residence boasts a standard Minergie construction, ensuring compliance with strict rules on energy efficiency in buildings, not to mention comfort of living.

Nur wenige Schritte vom bekannten Ferienort Gstaad entfernt, bietet diese Luxus-Residenz 4 Chalets an, die untereinander mit Garagen verbunden sind. Die Residenz beinhaltet 28 Wohnungen und 5 Geschäfte, die auf die 4 Chalets verteilt sind. Leitbild von diesem ambitionierten Projekt ist die Harmonie mit authentischen, modernen und umweltfreundlichen Materialien. Die Residenz verfügt über den Minergie-Standard, der die Einhaltung der strengen Vorschriften bezüglich Energieeffizienz in Gebäuden garantiert, ohne dabei die Lebensqualität zu vergessen.



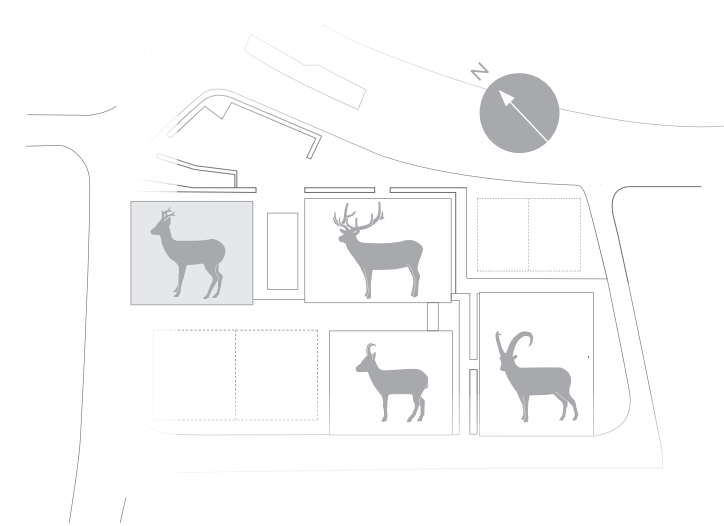

Ground floor - Erdgeschoss



MAG-01-1 TOTAL: 99,31 m²

- 1. Shop / Geschäftslokal 1 98,87 m²
- 2. WC 3,5 m²

MAG-01-2 TOTAL: 99,31 m²

- 3. Shop / Geschäft 96,98 m²
- 4. WC 3,5 m²

5. Treppenhaus 32,53 m²

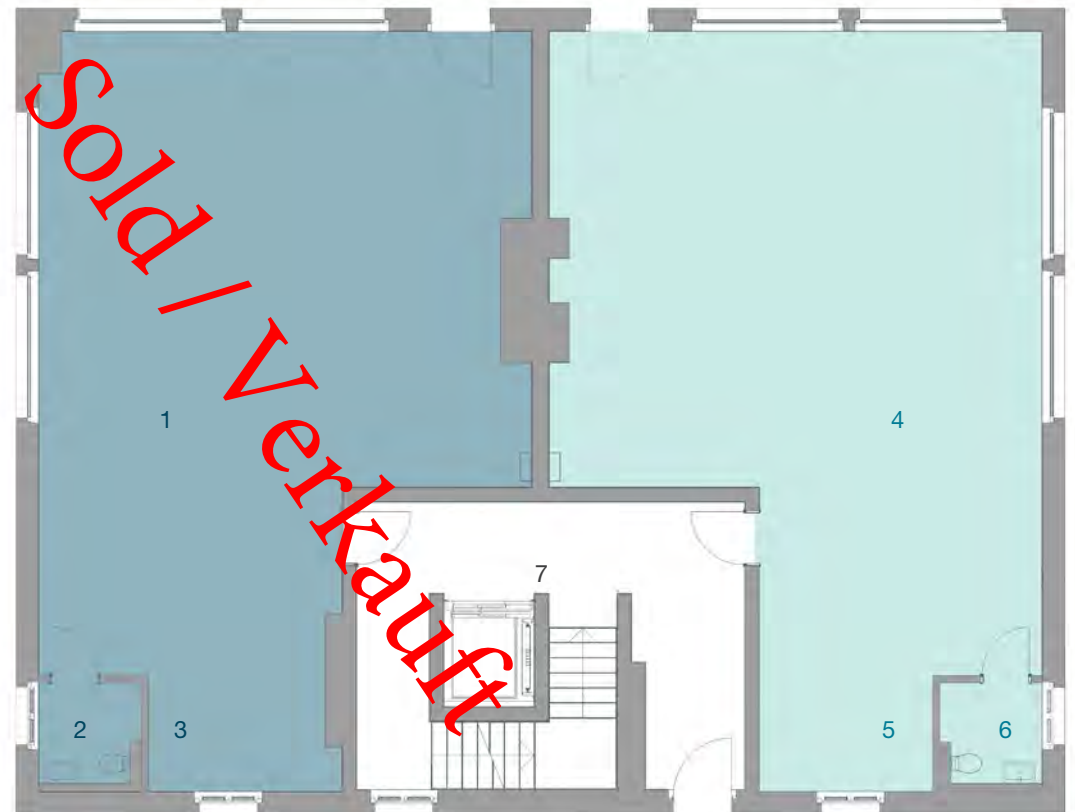

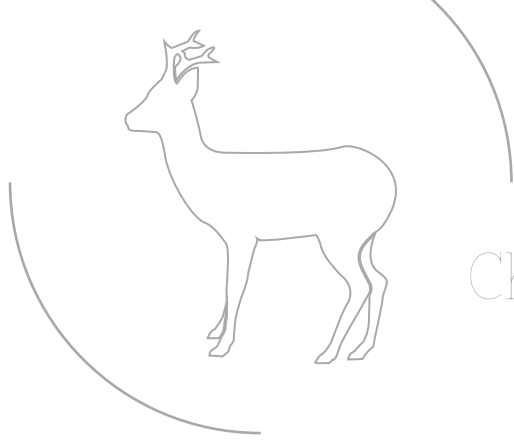

Chevreuil

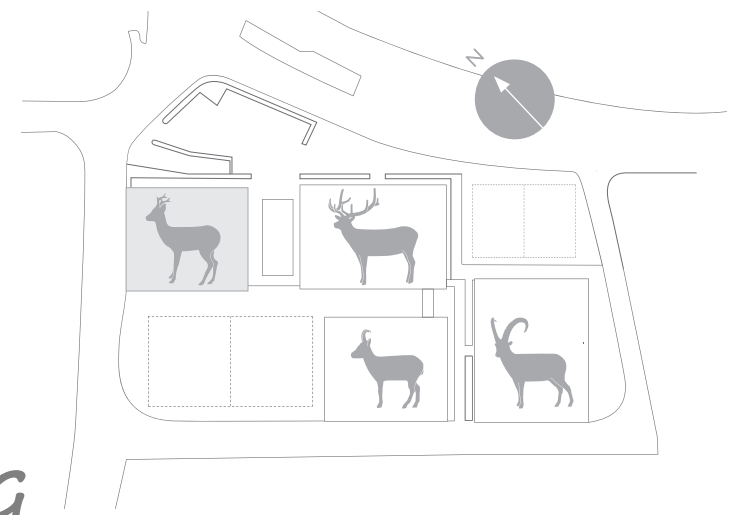

1st Floor - 1. OG

AP-01-1 TOTAL: 69,26 m²

- | | |
|--|---------------------|
| 1. Living - Dining - Kitchen /
Wohnzimmer - Essen - Küche | 35,2 m ² |
| 2. Room / Zimmer | 14,2 m ² |
| 3. Bathroom / Bad | 6,0 m ² |
| 4. Corridor - Cloakroom / Korridor - Garderobe | 5,0 m ² |
| 5. Entrance / Eingang | 3,4 m ² |

AP-01-2 TOTAL: 27,29 m²

- | | |
|--|---------------------|
| 6. Living - Dining /
Wohnzimmer - Essen | 15,8 m ² |
| 7. Entrance - Kitchen / Eingang - Küche | 4,5 m ² |
| 8. Bathroom / Bad | 4,4 m ² |

AP-01-3 TOTAL: 66,81 m²

- | | |
|--|---------------------|
| 9. Living - Dining - Kitchen /
Wohnzimmer - Essen - Küche | 35,6 m ² |
| 10. Room / Zimmer | 12,0 m ² |
| 11. Bathroom / Bad | 6,0 m ² |
| 12. Korridor / Garderobe | 4,9 m ² |
| 13. Entrance / Eingang | 3,4 m ² |

AP-01-4 TOTAL: 39,25 m²

- | | |
|--|---------------------|
| 14. Room / Zimmer | 11,1 m ² |
| 15. Entrance - Kitchen / Eingang - Küche | 6,9 m ² |
| 16. Living - Dining / Wohnzimmer - Essen | 13,7 m ² |
| 17. Bathroom / Bad | 4,0 m ² |

18. COM-01-2

21,76 m²



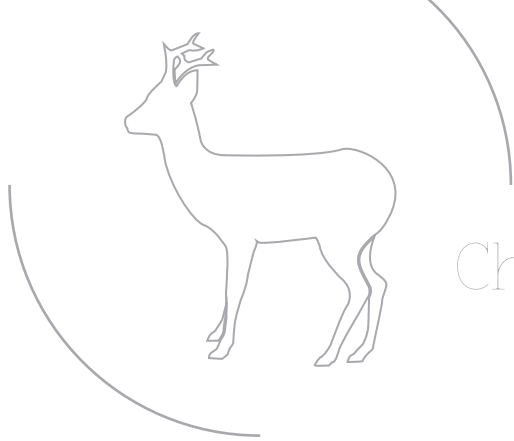

Chevreuril

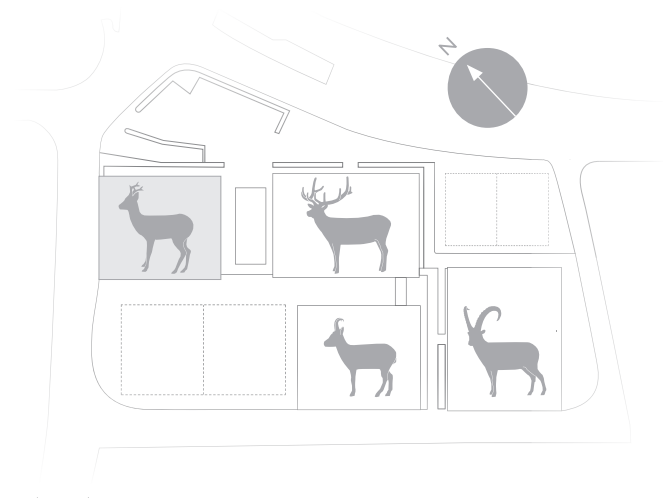

2nd Floor - 2. OG

AP-01-5 TOTAL: 106,70 m²

- | | |
|--|---------------------|
| 1. Living - Dining - Kitchen /
Wohnzimmer - Essen - Küche | 41,6 m ² |
| 2. Bathroom / Bad | 7,7 m ² |
| 3. Room / Zimmer 2 | 12,7 m ² |
| 4. Entrance - Corridor - Cloakroom /
Eingang - Korridor - Garderobe | 10,0 m ² |
| 5. Room / Zimmer 1 | 17,5 m ² |
| 6. WC | 1,4 m ² |
| 7. Bathroom / Bad | 7,6 m ² |

AP-01-6 TOTAL: 108,66 m²

- | | |
|--|---------------------|
| 9. Living - Dining - Kitchen /
Wohnzimmer - Essen - Küche | 42,0 m ² |
| 10. Bathroom / Bad | 7,8 m ² |
| 11. Room / Zimmer 2 | 13,2 m ² |
| 12. WC | 1,7 m ² |
| 13. Entrance / Eingang | 9,7 m ² |
| 14. Bathroom / Bad | 8,2 m ² |
| 15. Room / Zimmer 2 | 17,5 m ² |

16. COM-01-3 14,49 m²

























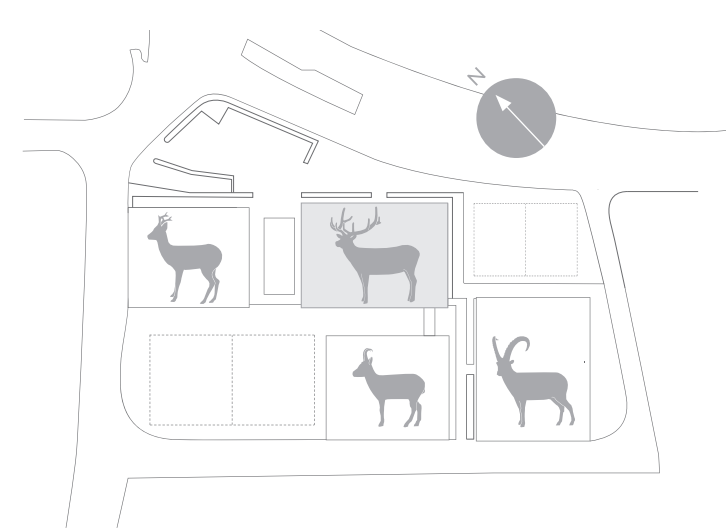

Ground floor - Erdgeschoss

MAG-02-1 TOTAL: 109,8 m²

- 1. Shop / Geschäft 111,38 m²
- 2. WC 4,3 m²

MAG-02-2 TOTAL: 50,1 m²

- 3. Shop / Geschäft 51,05 m²
- 4. WC 3,4 m²

MAG-02-3 TOTAL: 110,2 m²

- 5. Shop / Geschäft 110,67 m²
- 6. WC 4,3 m²
- 7. Treppenhaus 33,8 m²

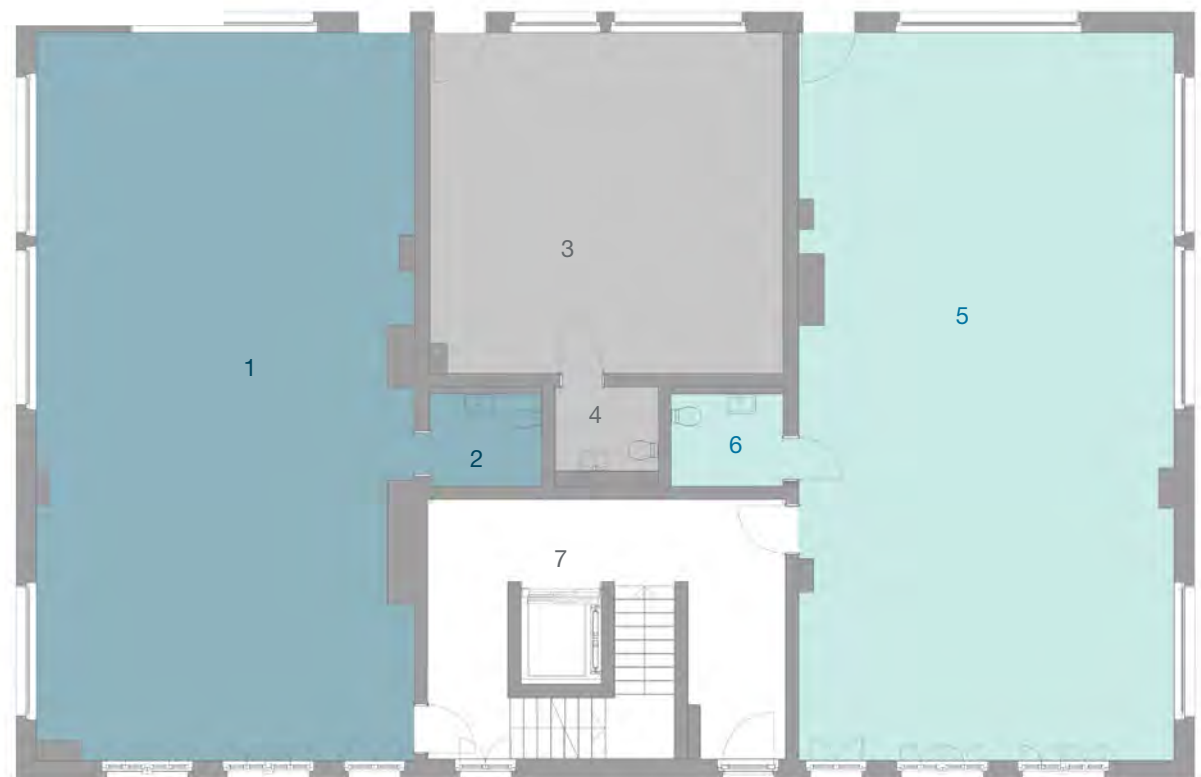

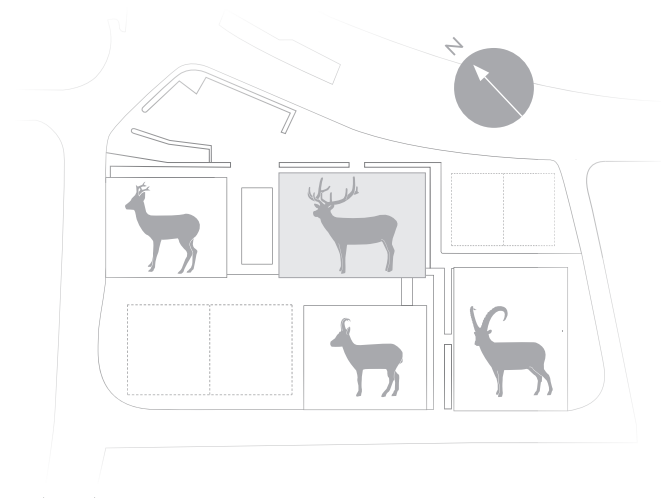
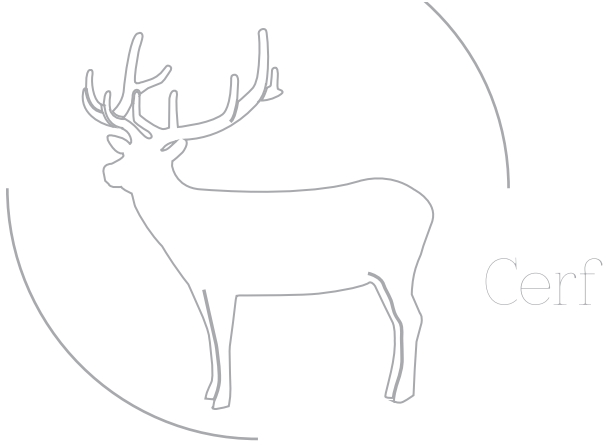

1st Floor - 1. OG

AP-02-1 TOTAL: 137,5 m²

1. Living - Dining - Kitchen / Wohnzimmer - Essen - Küche	58,9 m ²
2. Room / Zimmer 3	11,9 m ²
3. Bathroom / Bad 3	3,9 m ²
4. Bathroom /Bad 1	5,3 m ²
5. Corridor / Korridor	5,8 m ²
6. Entrance / Eingang	7,2 m ²
7. WC	1,6 m ²
8. Room / Zimmer 1	13,8 m ²
9. Room / Zimmer 2	15,1 m ²
10. Bathroom / Bad 2	3,2 m ²

AP-02-2 TOTAL: 149,1 m²

13. Living - Dining - Kitchen / Wohnzimmer - Essen - Küche	60,4 m ²
14. Room / Zimmer 3	11,8 m ²
15. Bathroom / Bad 3	3,7 m ²
16. Corridor / Korridor	7,6 m ²
17. Bathroom/ Bad 2	3,7 m ²
18. Room / Zimmer 2	14,1 m ²
19. Room / Zimmer 1	18,9 m ²
20. Bathroom / Bad 1	6,1 m ²
21. Utility / Waschen	1,5 m ²
22. Entrance / Eingang	6,5 m ²
23. WC	2,2 m ²

24. COM-0

23,33 m²









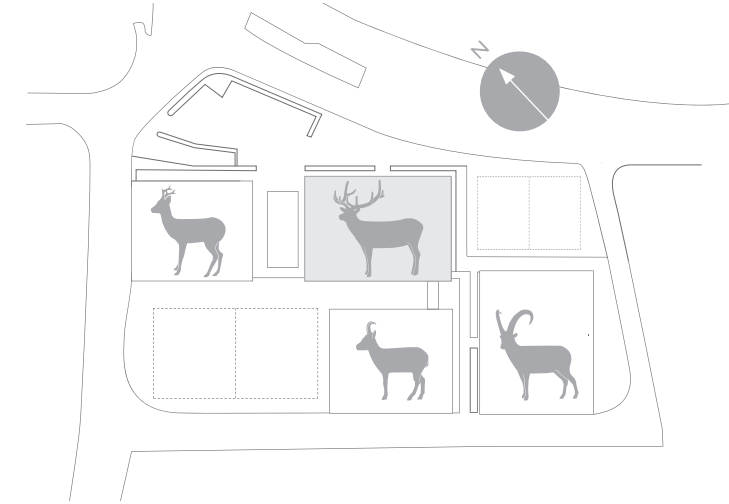
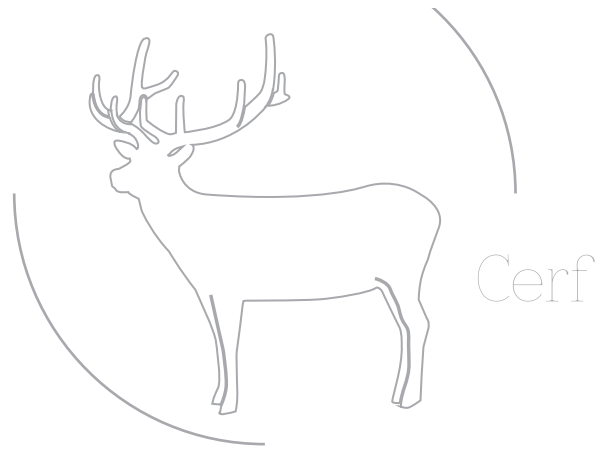

2nd Floor - 2. OG

AP-02-3 TOTAL: 137,74 m²

1. Living - Dining - Kitchen / Wohnzimmer - Essen - Küche	58,9 m ²
2. Room / Zimmer 3	11,9 m ²
3. Bathroom / Bad 3	25,6 m ²
4. Bathroom /Bad 1	5,3 m ²
5. Corridor / Korridor	5,8 m ²
6. Entrance / Eingang	7,2 m ²
7. Room / Zimmer 1	13,8 m ²
8. Room / Zimmer 2	15,1 m ²
9. Bathroom / Bad 2	3,2 m ²
10. WC	1,6 m ²

AP-02-4 TOTAL: 149,32 m²

13. Living - Dining - Kitchen / Wohnzimmer - Essen - Küche	60,4 m ²
14. Room / Zimmer 3	11,9 m ²
15. Bathroom / Bad 3	3,7 m ²
16. Corridor / Korridor	7,5 m ²
17. Bathroom / Bad 2	3,7 m ²
18. Room / Zimmer 2	14,0 m ²
19. Room / Zimmer 1	18,9 m ²
20. Bathroom / Bad 1	2,3 m ²
21. Utility / Waschen	1,5 m ²
22. Entrance / Eingang	6,5 m ²
23. WC	1,6 m ²

24. COM-0

23,32 m²

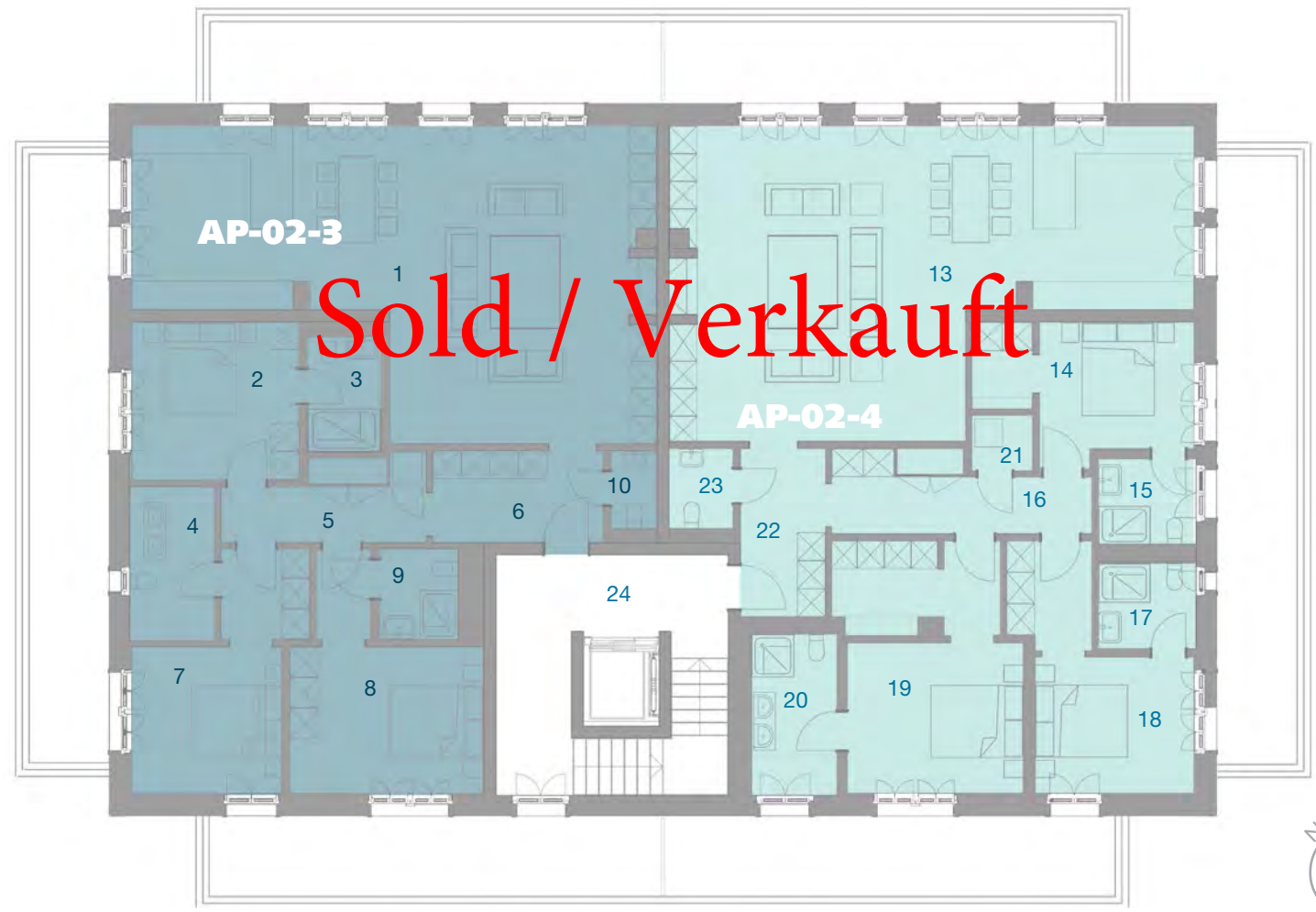

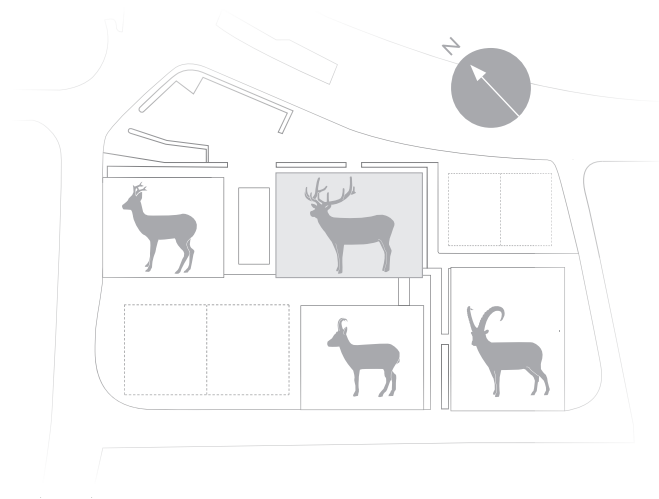
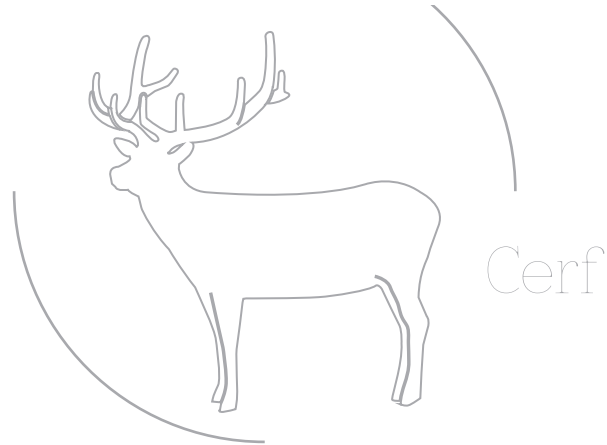

3rd Floor - 3. OG

AP-02-5-2 TOTAL: 256,26 m²

1. Living - Dining - Kitchen / Wohnzimmer - Essen - Küche	82,2 m ²
2. Bathroom / Bad	7,1 m ²
3. Room / Zimmer	25,3 m ²
4. Reduit	3,3 m ²
5. Bathroom / Bad 2	5,2 m ²
6. Corridor / Korridor	3,15 m ²
7. Room / Zimmer 2	17,9 m ²
8. Entrance / Eingang	17,4 m ²
9. Lounge	11,7 m ²
10. Bathroom / Bad 5	3,4 m ²
11. Room / Zimmer 5	14,8 m ²
12. Corridor / Korridor	5,9 m ²
13. Room / Zimmer 4	12,2 m ²
14. Bathroom / Bad 4	3,2 m ²
15. Utility / Waschen	2,3 m ²
16. WC	1,8 m ²
17. Room / Zimmer 3	14,1 m ²
18. Bathroom / Bad 3	4,6 m ²
19. COM-0	13,88 m ²

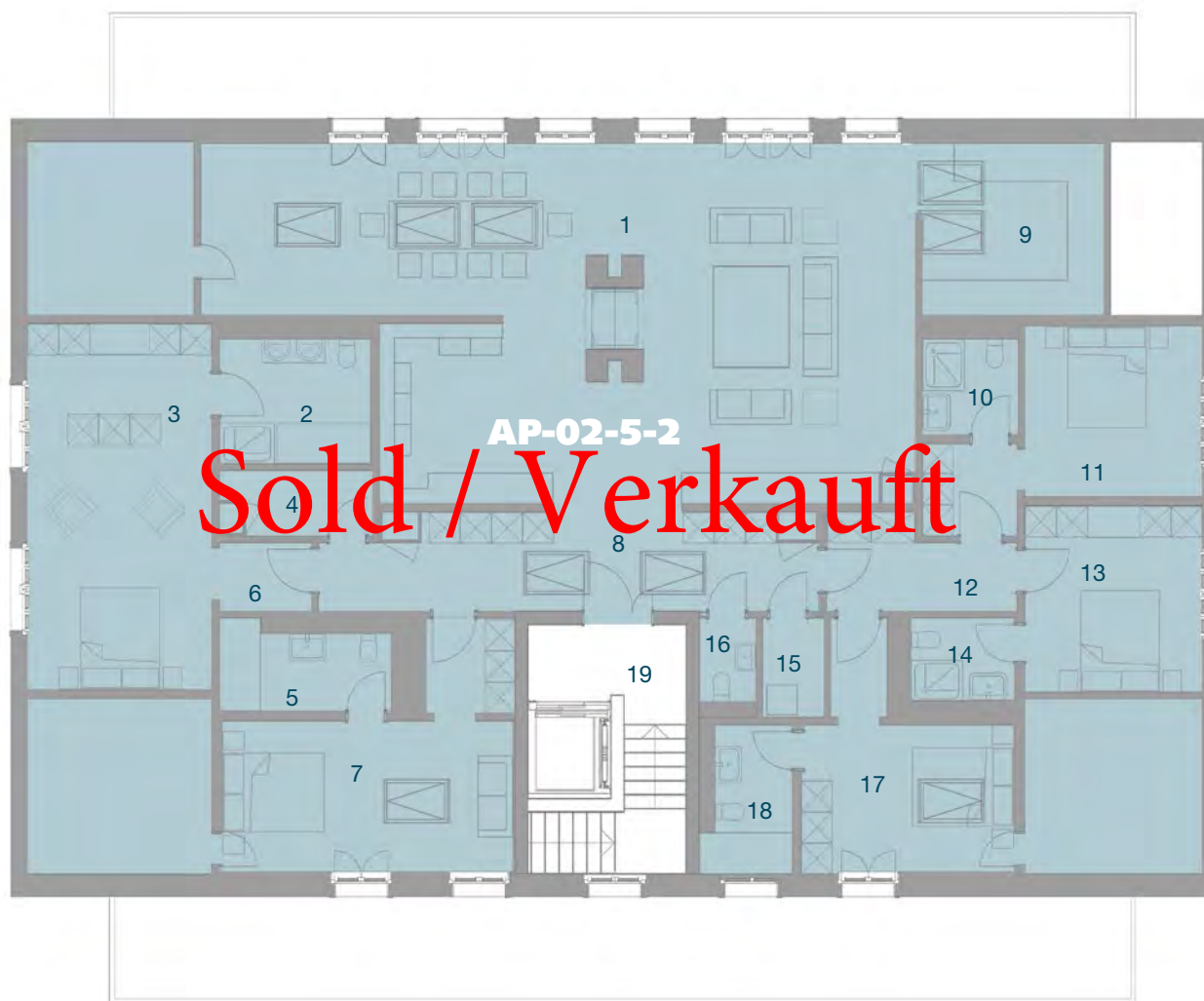



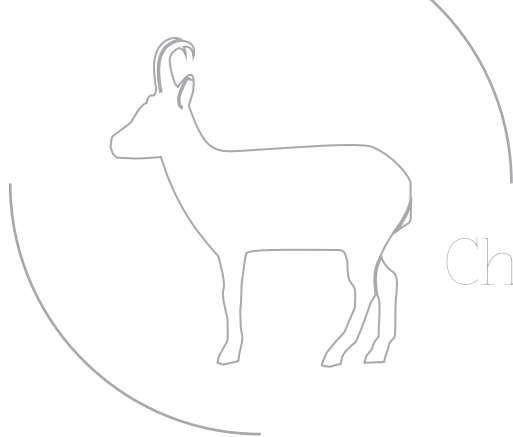

Chamois

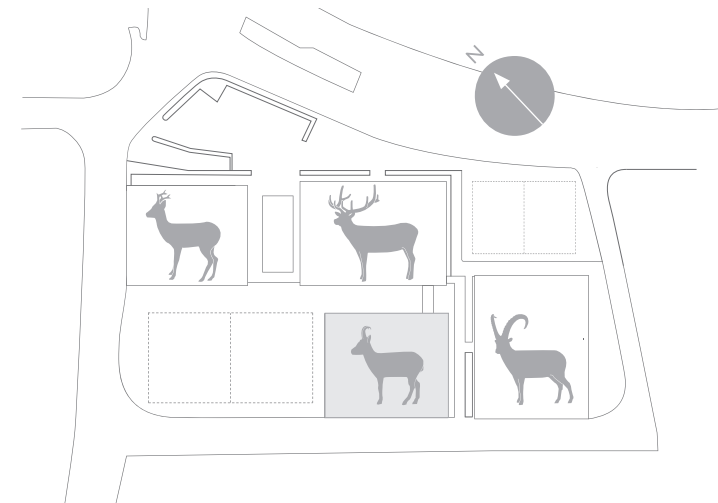

Ground floor - Erdgeschoss

AP-03-1 TOTAL: 116,29 m²

1.	Room / Zimmer 1	15,4 m ²
2.	Bathroom / Bad 1	7,0 m ²
3.	Corridor / Korridor	4,9 m ²
4.	Entrance / Eingang	10,7 m ²
5.	Room / Zimmer 2	14,8 m ²
6.	Bathroom / Bad 2	8,7 m ²
7.	WC	2,3 m ²
8.	Living - Dining - Kitchen / Wohnzimmer - Essen - Küche.	38,8 m ²
9.	Utility / Waschen	3,8 m ²

AP-03-2 TOTAL: 116,30 m²

10.	Room / Zimmer 1	15,4 m ²
11.	Bathroom / Bad 1	7,0 m ²
12.	Corridor / Korridor	4,9 m ²
13.	Entrance / Eingang	10,7 m ²
14.	Room / Zimmer 2	14,8 m ²
15.	WC	2,1 m ²
16.	Bathroom / Bad 2	8,7 m ²
17.	Living - Dining - Kitchen / Wohnzimmer - Essen - Küche	39,1 m ²
18.	Utility / Waschen	3,4 m ²

19. COM-0

22,29 m²



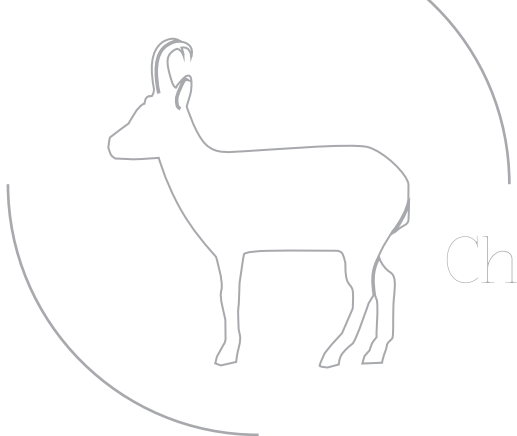

Chamois

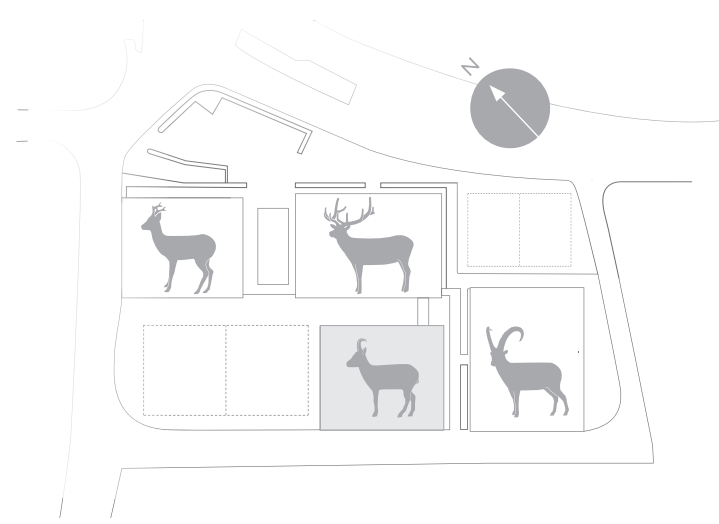

1st Floor - 1. OG

AP-03-3 TOTAL: 115,25 m²

- 1. Room / Zimmer 1 15,1 m²
- 2. Bathroom / Bad 1 7,0 m²
- 3. Corridor / Korridor 4,6 m²
- 4. Entrance / Eingang 10,8 m²
- 5. Room / Zimmer 2 14,6 m²
- 6. Bathroom / Bad 2 8,5 m²
- 7. WC 2,3 m²
- 8. Living - Dining - Kitchen / Wohnzimmer - Essen - Küche. 38,8 m²
- 9. Utility / Waschen 3,8 m²

AP-03-4 TOTAL: 115,26 m²

- 10. Room / Zimmer 1 15,1 m²
- 11. Bathroom / Bad 1 7,0 m²
- 12. Corridor / Korridor 4,6 m²
- 13. Entrance / Eingang 10,8 m²
- 14. Room / Zimmer 2 16,6 m²
- 15. WC 2,1 m²
- 16. Bathroom / Bad 2 8,5 m²
- 17. Living - Dining - Kitchen / Wohnzimmer - Essen - Küche 38,8 m²
- 18. Utility / Waschen 3,4 m²

19. COM-0 21,76 m²



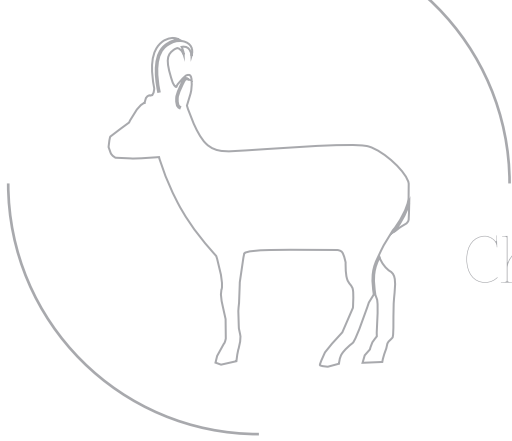

Chamois

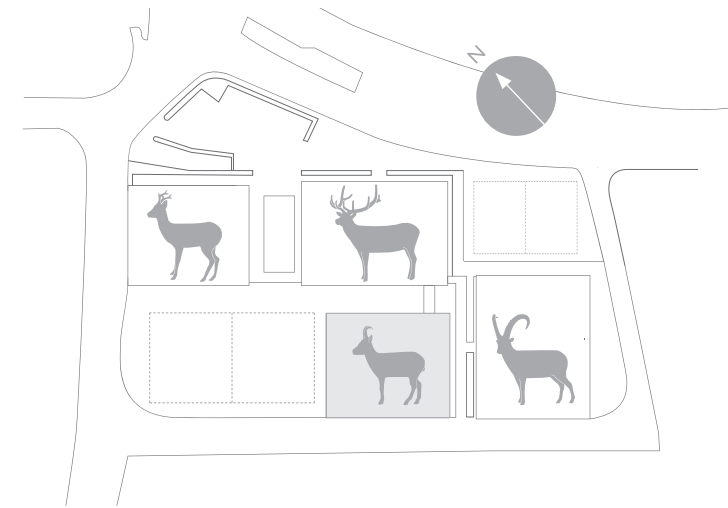

2nd Floor - 2. OG

AP-03-5 TOTAL: 115,25 m²

1. Room / Zimmer 1	15,1 m ²
2. Bathroom / Bad 1	7,0 m ²
3. Corridor / Korridor	4,6 m ²
4. Entrance / Eingang	10,8 m ²
5. Room / Zimmer 2	14,6 m ²
6. Bathroom / Bad 2	8,5 m ²
7. WC	2,3 m ²
8. Living - Dining - Kitchen / Wohnzimmer - Essen - Küche.	38,8 m ²
9. Utility / Waschen	3,8 m ²

AP-03-6 TOTAL: 115,26 m²

10. Room / Zimmer 1	15,1 m ²
11. Bathroom / Bad 1	7,0 m ²
12. Corridor / Korridor	4,6 m ²
13. Entrance / Eingang	10,8 m ²
14. Room / Zimmer 2	14,6 m ²
15. WC	2,1 m ²
16. Bathroom / Bad 2	8,5 m ²
17. Living - Dining - Kitchen / Wohnzimmer - Essen - Küche	38,8 m ²
18. Utility / Waschen	3,4 m ²

19. COM-0 22,10 m²

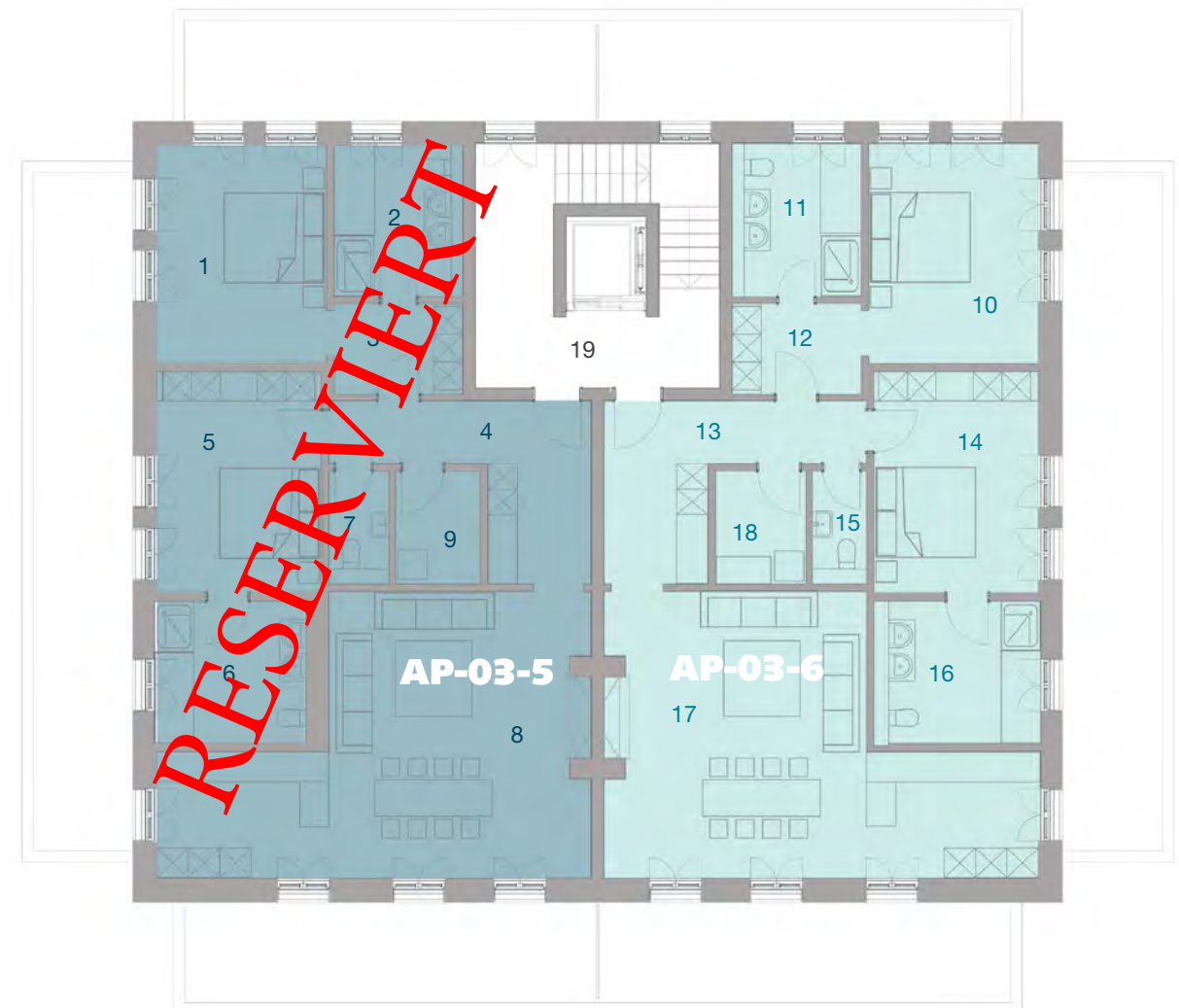



















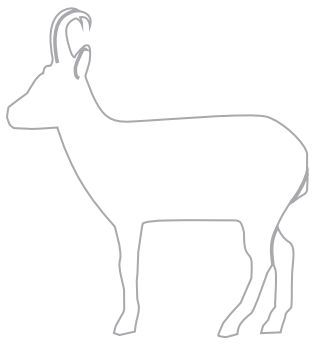

Chamois

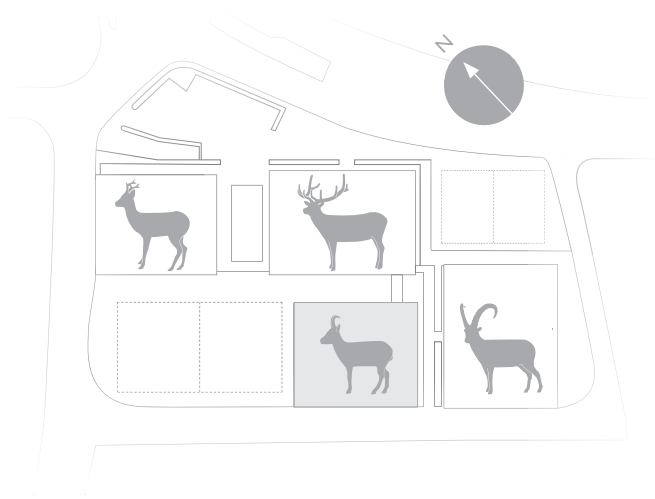

3rd Floor - 3. OG

AP-03-7-2 TOTAL: 233,64 m²

- | | |
|---|---------------------|
| 1. Room / Zimmer 2 | 17,9 m ² |
| 2. Bathroom / Bad | 6,6 m ² |
| 3. Entrance / Eingang | 21,3 m ² |
| 4. Room / Zimmer | 7,6 m ² |
| 5. Corridor / Korridor | 5,6 m ² |
| 6. Bathroom / Bad | 7,6 m ² |
| 7. Living - Dining / Wohnzimmer - Essen | 66,9 m ² |
| 8. Lounge | 14,3 m ² |
| 9. Utility / Waschen | 2,6 m ² |
| 10. WC | 2,6 m ² |
| 11. Room / Zimmer 3 | 19,0 m ² |
| 12. Bathroom / Bad | 6,7 m ² |
| 13. Room / Zimmer 4 | 24,5 m ² |

16. COM-0 10,32 m²

































level -1 Garage



- | | | |
|-----|----------------------------------|----------------------|
| 1. | Technical room / Technikarium | 20,70 m ² |
| 2. | Electrical room / Elektrotechnik | 5,90 m ² |
| 3. | Storage 1 / Lager 1 | 11,10 m ² |
| 4. | Storage 2 /Lager 2 | 11,10 m ² |
| 5. | Cellar 1 / Keller 1 | 23,10 m ² |
| 6. | Cellar 2 / Keller 2 | 22,60 m ² |
| 7. | Cellar 3 / Keller 3 | 16,10 m ² |
| 8. | Cellar 4 / Keller 4 | 16,10 m ² |
| 9. | Cellar 5 / Keller 5 | 21,70 m ² |
| 10. | Cellar 6 / Keller | 23,30 m ² |
| 11. | Cellar 7 / Keller 7 | 22,50 m ² |
| 12. | Technical room / Technikarium | 25,00 m ² |
| 13. | Storage 3 / Lager 3 | 10,80 m ² |
| 14. | Electrical room / Elektrotechnik | 6,70 m ² |
| 15. | Storage 4 / Lager 4 | 9,60 m ² |
| 16. | Cellar 8 / Keller 8 | 23,50 m ² |
| 17. | Cellar 9 / Keller 9 | 22,10 m ² |
| 18. | Cellar 10 / Keller 10 | 23,40 m ² |
| 19. | Cellar 11 / Keller 11 | 24,50 m ² |
| 20. | Cellar 12 / Keller 12 | 20,40 m ² |
| 21. | Electrical room / Elektrotechnik | 7,30 m ² |
| 22. | Technical room / Technikarium | 37,70 m ² |
| 23. | Cellar 13 / Keller 13 | 22,70 m ² |
| 24. | Cellar 14 / Keller 14 | 20,70 m ² |
| 25. | Cellar 15 / Keller 15 | 20,20 m ² |
| 26. | Cellar 16 / Keller 16 | 20,10 m ² |
| 27. | Cellar 17 / Keller 17 | 24,70 m ² |
| 28. | Cellar 18 / Keller 18 | 24,10 m ² |
| 29. | Shelter / Schutzraum | 44,40 m ² |

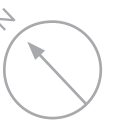





1

2

3

3





IMMOBILIEN
FOR SALE
SEE PAGES 10-11

8-2

2023786-S

BE 536 683